

Tiger Pro 72HC 72HL-(V) 535-555 Watt MONO-FACIAL MODULE

P-Type

Positive power tolerance of 0~+3%

IEC61215(2016), IEC61730(2016)

ISO9001:2015: Quality Management System

ISO14001:2015: Environment Management System

ISO45001:2018

Occupational health and safety management systems

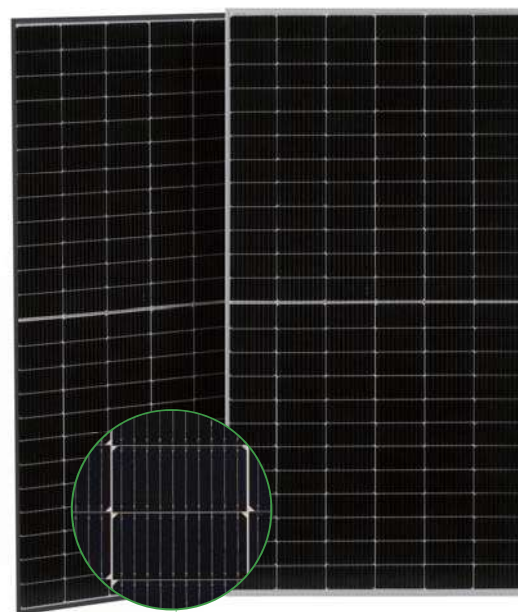

MBB HC Technology

Key Features



Multi Busbar Technology

Better light trapping and current collection to improve module power output and reliability.



Durability Against Extreme Environmental Conditions

High salt mist and ammonia resistance.



Reduced Hot Spot Loss

Optimized electrical design and lower operating current for reduced hot spot loss and better temperature coefficient.

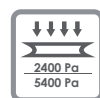

Enhanced Mechanical Load

Certified to withstand: wind load (2400 Pascal) and snow load (5400 Pascal).



Longer Life-time Power Yield

0.55% annual power degradation and 25 year linear power warranty.



POSITIVE QUALITY™
Common Quality Assurance

LINEAR PERFORMANCE WARRANTY

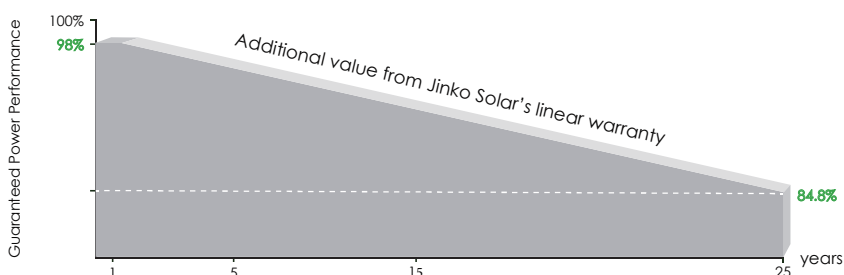

15 Year Product Warranty

25 Year Linear Power Warranty

0.55% Annual Degradation Over 25 years

Engineering Drawings

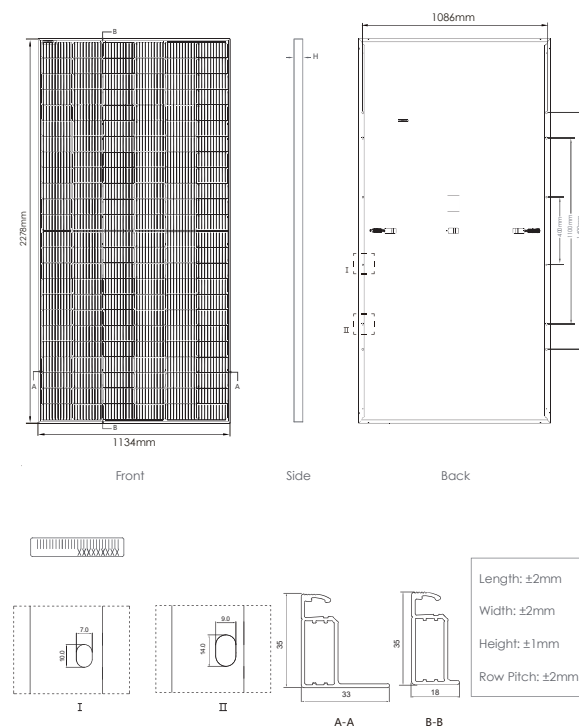

Packaging Configuration

(Two pallets = One stack)

31 pcs/pallets, 62 pcs/stack, 620 pcs/ 40'HQ Container

Electrical Performance & Temperature Dependence

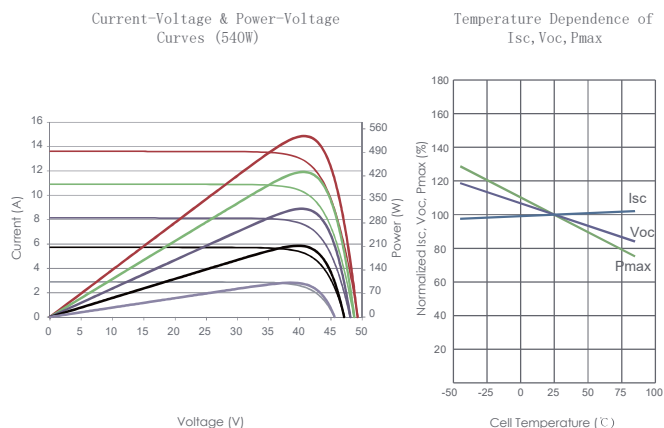

Mechanical Characteristics

Cell Type	P type Mono-crystalline
No. of cells	144 (6×24)
Dimensions	2278×1134×35mm (89.69×44.65×1.38 inch)
Weight	28 kg (61.73 lbs)
Front Glass	3.2mm, Anti-Reflection Coating, High Transmission, Low Iron, Tempered Glass
Frame	Anodized Aluminium Alloy
Junction Box	IP68 Rated
Output Cables	TUV 1×4.0mm ² (+): 400mm, (-): 200mm or Customized Length

SPECIFICATIONS

Module Type	JKM535M-72HL4		JKM540M-72HL4		JKM545M-72HL4		JKM550M-72HL4		JKM555M-72HL4	
	JKM535M-72HL4-V		JKM540M-72HL4-V		JKM545M-72HL4-V		JKM550M-72HL4-V		JKM555M-72HL4-V	
	STC	NOCT	STC	NOCT	STC	NOCT	STC	NOCT	STC	NOCT
Maximum Power (Pmax)	535Wp	398Wp	540Wp	402Wp	545Wp	405Wp	550Wp	409Wp	555Wp	413Wp
Maximum Power Voltage (Vmp)	40.63V	37.91V	40.70V	38.08V	40.80V	38.25V	40.90V	38.42V	40.99V	38.59V
Maximum Power Current (Imp)	13.17A	10.50A	13.27A	10.55A	13.36A	10.60A	13.45A	10.65A	13.54A	10.70A
Open-circuit Voltage (Voc)	49.34V	46.57V	49.42V	46.65V	49.52V	46.74V	49.62V	46.84V	49.72V	46.93V
Short-circuit Current (Isc)	13.79A	11.14A	13.85A	11.19A	13.94A	11.26A	14.03A	11.33A	14.12A	11.40A
Module Efficiency STC (%)	20.71%		20.90%		21.10%		21.29%		21.48%	
Operating Temperature (°C)	-40°C~+85°C									
Maximum system voltage	1000/1500VDC (IEC)									
Maximum series fuse rating	25A									
Power tolerance	0~+3%									
Temperature coefficients of Pmax	-0.35%/°C									
Temperature coefficients of Voc	-0.28%/°C									
Temperature coefficients of Isc	0.048%/°C									
Nominal operating cell temperature (NOCT)	45±2°C									

*STC: Irradiance 1000W/m²

Cell Temperature 25°C

AM=1.5

NOCT: Irradiance 800W/m²

Ambient Temperature 20°C

AM=1.5

Wind Speed 1m/s